

RESILIENT SEATED GATE VALVE (FLANGED END)

SIZES: DN50 TO DN1200

PN 10 | PN 16



FEATURES

- Compact and Rugged Construction.
- Tight shut-off leakage class.
- Ductile Iron Body & Disc allows high impact and stretching resistance.
- With Full Bore design complying to IS 14846 Standard, ensures minimized pressure loss and increased energy efficiency.
- Maintenance free valve design.
- Fully encapsulated ductile iron wedge.
- Fully EPDM vulcanized wedge maintains full stop of flow and can absorb smaller particles in the flow.
- Stainless steel stem with threads for high strength.
- Maintenance-free and corrosion-resistant multi stem O-rings ensures higher durability.
- Brass wedge nut provides fixation of the stem and low torques.
- With isolated bonnet nuts, no risk of corrosion.
- Bidirectional use. Possible to install on horizontal and vertical pipelines with varied flow directions.
- Fixed wedge structures prevent vibration.
- With precise machined stem, ensures low torque requirements during operation.
- Corrosion Resistant fusion bonded epoxy coated body and bonnet.
- Full coating on the body and disc internally & externally with an average of 250 microns.
- For big size valves, balanced positioned lifting holes on the body ease transportation and installation
- Suitable for vacuum conditions.
- Suitable for shut-off and isolation purposes.
- Can be operated with hand wheel, gearbox, Electrical actuator and spindle.
- Low operational Torque.
- Maintenance friendly – Easy replacement of internal parts.

ISO 9001:2015

BUREAU VERITAS
Certification



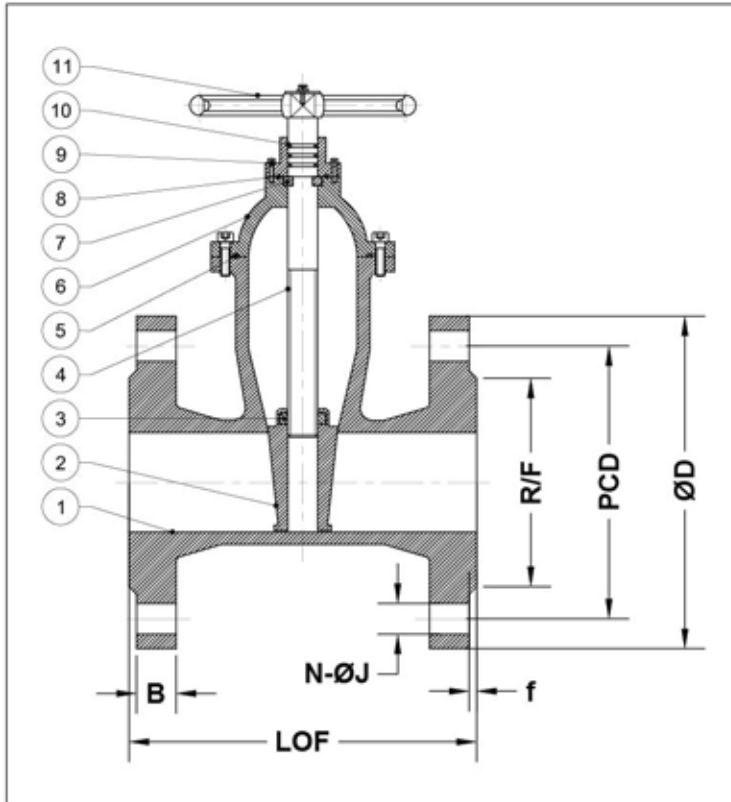

RESILIENT SEAT GATE VALVE DETAILS:

Design And Mfg. Std : BS 5163
 Face To Face : BS 5163
 Flanged End : EN 1092-2

NO.	DESCRIPTION	MATERIAL
1	BODY	DUCTILE IRON / CAST IRON
2	WEDGE	DUCTILE IRON / CAST IRON + EPDM
3	STEM NUT	BRASS
4	STEM	AISI 410
5	GASKET	EPDM
6	BONNET	DUCTILE IRON / CAST IRON
7	LOCATING RING	BRASS
8	O RING	EPDM
9	BOLTS	CARBON STEEL 8.8
10	O-RING	EPDM
11	HAND WHEEL / CAP	DUCTILE IRON / CAST IRON
--	FASTENERS	CARBON STEEL 4.8

TEST PRESSURE		
TESTING	BODY	SEAT
HYDRAULIC	24 kg/cm ²	16 kg/cm ²

VALVE SIZE	LOF	ØD	PCD	R/F	B	f	N-ØJ	QTY
Tolerance	±5mm	±5mm	±1.5mm	±2mm	±3mm	±1.5mm	±1.5mm	
2"(50mm)	178	165	125	99	19	3	4-19	01
2.1/2"(65mm)	190	185	145	119	19	3	4-19	01
3"(80mm)	203	200	160	133	19	3	8-19	01
4"(100mm)	229	220	180	154	19	3	8-19	01
5"(125mm)	254	250	210	184	19	3	8-19	01
6"(150mm)	267	285	240	210	19	3	8-23	01
8"(200mm)	292	340	295	265	20	3	12-23	01
10"(250mm)	330	405	355	319	22	3	12-28	01
12"(300mm)	356	460	410	370	24.5	4	12-28	01
14"(350mm)	381	520	470	429	26.5	4	16-28	01
16"(400mm)	406	580	525	480	28	4	16-31	01
18"(450mm)	432	640	585	548	30	4	20-31	01
20"(500mm)	457	715	650	609	31.5	4	20-34	01
24"(600mm)	508	840	770	720	36	5	20-37	01
28"(700mm)	610	910	840	794	40	5	24-37	01
32"(800mm)	660	1025	950	901	44	5	24-41	01
36"(900mm)	711	1125	1050	1001	47	5	28-40	01
40"(1000mm)	811	1255	1170	1112	50	5	28-43	01
48"(1200mm)	1015	1485	1390	1328	57	5	32-49	01

STANDARD GEAR BOX AVAILABLE ON REQUEST FOR HIGHER SIZES
 ALL DIMENSIONS ARE IN MM UNLESS OTHERWISE SPECIFIED

REGISTERED FACTORY AND OFFICE
ROYALTECH VALVES
 #B-492/B, 2ND GATE INDUSTRIAL ESTATE
 GOKUL ROAD, HUBLI-580030
 KARNATAKA, INDIA

FOR ENQUIRY, CONTACT US AT

+91 90198 20791 | 97383 48007

sales.royaltechvalves@gmail.com

FOR FURTHER DETAILS, VISIT OUR WEBSITE

www.royaltechvalves.com